

ATTACHING STEM CORD GRIP

EXPANDED VIEW INSTALLATION GUIDE

To attach stem cord grip:

- 1.** With screwdriver, loosen set screw until Stem Cord Grip moves freely.
- 2.** Insert Stem Cord Grip into Cluster Body and turn clockwise to tighten.
- 3.** Tighten set screw
- 4.** Enjoy your new fixture!

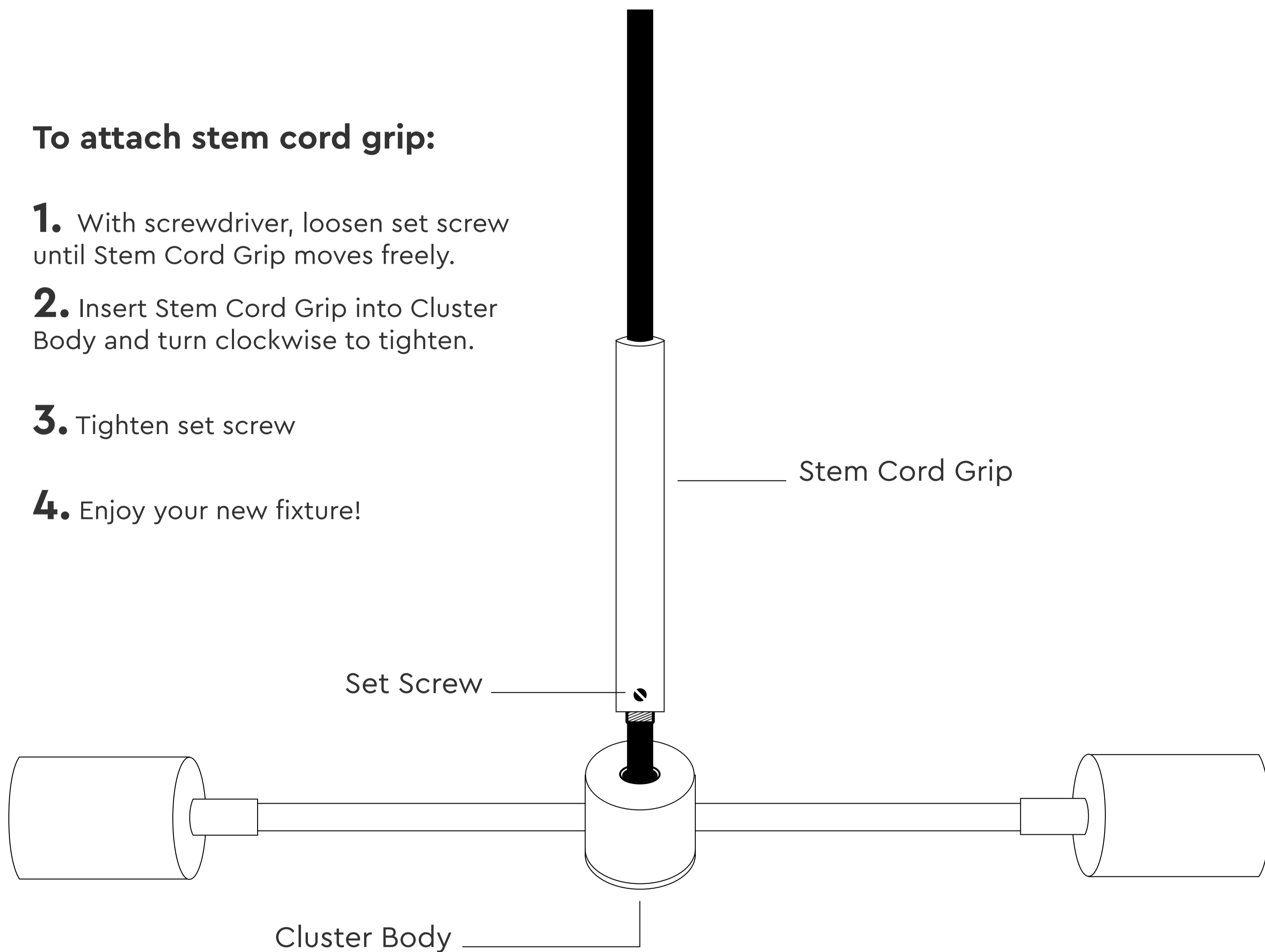

Need more info? Visit our guides page at [COLORCORD.COM/PAGES/GUIDES](https://colorcord.com/pages/guides)